

## EN C-06 M ELEVATOR STOP DOOR LOCK ASSEMBLY-ADJUSTMENT AND MAINTENANCE GUIDE

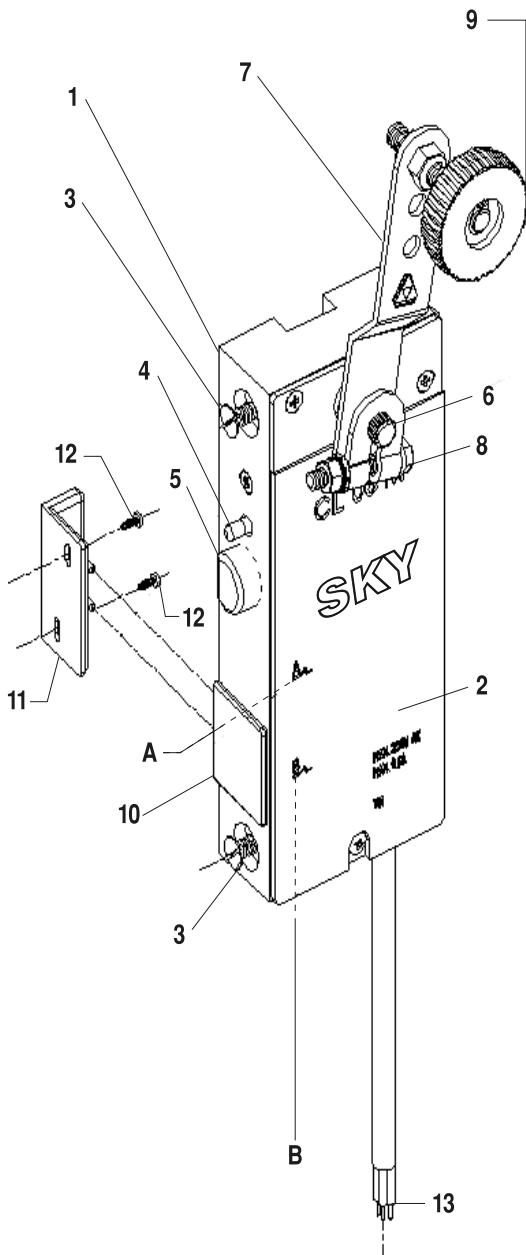

### ASSEMBLY-ADJUSTMENT INSTRUCTION

- 1) Detach M6 bolts (No:3) on the front surface of Lock Body (No:1)
- 2) Mount the lock body on the door frame by using M6 bolts (No:3).
- 3) Apply lock opening handle (No:7) by matching Mechanism Pulling Handle (No:6) to serrated part of arbor and to match to the outside of whell body (No:9).
- 4) Tighten lock opening handle clamp tightening bolt (No:8), according to lock opening handle's lock opening magnet's (lirpump)working position.
- 5) Apply socket contact group (No:11) by using socket contact group's assembly bolts (No:12) to the door wing by bringing it to the same level with socket contact's opposite (No:10) contact group.
- 6) Do fine centerline adjustment by using the channels of socket contact group's (No:12) assembly bolts and the channels taking place on the socket contact body (No: 11).
- 7) For the connection of electricity: mountings of the cable can be done by using the cable ends of the cable bundle (No:13) and the connector given in the sack.

Internal security taking place on the transparent cover of the Lock Body (No:2) and it is marked with letter A, contact group place opposite of socket contact is marked with letter B.

**A** : Internal security contact group cables are in White color.

**B** : socket contact opposite contact group's cables are in Black color and do the connection being in compliance with the cables coming from the control panel.

The color of the grounding cable is Yellow by having Green lines on it and connect it to the grounding cable taking place in the electricity installation.

In order to de-activate the PRE-SECURITY system added to C 06 M Elevator Stop Door Lock, it is required that 2nd Security arbor (No: 4) must be projected out as 1,5 millimeters from it's hole taking place in the frame. However, after doing this, Locking System passes to locking process. If the hole taking place in the frame for the 2nd Security arbor to project out is blocked due to any undesired reason, in such a case, the lock blocks itself and it does not operate (If the radius of the hole taking place in the frame for the 2nd Security arbor to project out is small, enlargen the hole by using Ø7 drill).

Pre-security system is developed to have the space between the Elevator's frame and wing to be minimum 2 millimeters. In the event of having this space less, it will not be possible for the pre-security system to be active and de-activated.

### MAINTENANCE INSTRUCTION

- 1) Liquid oils must be used instead of solid oils during monthly routine maintenances of the elevator as solid oils accumulate dust and dirt on the working parts.
- 2) Check correct working conditions during monthly routine maintenances of the elevator as indicated during the installation.
- 3) Do not apply unsuggested intervention on the elevator.
- 4) Do not disassemble inside of the Lock even if it is for repair and maintenance.
- 5) During the general maintenance; if the door of the elevator required to be painted, Lock must be dismantled and it must be mounted in it's original place after the completion of the painting process. Residues of the paint entering in the working parts may cause problems for the oprations of the Lock and Paint Removers may cause harm on the plastic parts.
- 6) During monthly routine controls of the elevator, if there are situations to cause obstacles for the conductance of the contacts, apply proper cleaning to eliminate unfavourable conditions of the elevator. If the contacts are required to be replaced, please contact our company.
- 7) Operation life of the product is 10 (ten) years. Guarantee Period is 2 (two) years.